

EMERGENCY RESPONSE VEHICLES

FRONTLINE
COMMUNICATIONS



PERFORM. LIKE NO OTHER.

EMERGENCY RESPONSE TEAMS DEMAND INCREASINGLY SOPHISTICATED SYSTEMS TO SECURELY CAPTURE AND TRANSMIT MISSION INTELLIGENCE. THEY RELY ON FRONTLINE COMMUNICATIONS. FROM SMALL RAPID DEPLOYMENT PLATFORMS TO 53' MOBILE COMMAND TRAILERS, FRONTLINE VEHICLES KEEP RESPONSE TEAMS SAFE, MOBILE AND CONNECTED ON DEPLOYMENT.



Your mission is our mission



We go beyond moving equipment to the incident to integrate specialized, responsive solutions around specific mission demands. Whatever you require – negotiation space, deployment flexibility, a custom aluminum body with a commercial or Pierce® custom chassis – our vehicle design engineers have the expertise to get it exactly right.

- State-of-the-art 3-D modeling tools for precision design and analysis of all critical vehicle components.
- Slide-out sections expand interior space.
- Completely integrated electrical system (does not start/end with DC vehicle system/AC power system) for maximum operator control.
- Ergonomically-designed driver controls/work stations.
- Robust power control panels withstand years of use.
- 10-year limited body warranty.

System design experience includes, but is not limited to: all DC vehicle systems including multiplex control logic, and AC power utility systems for single phase, three-phase, domestic and all international standards.



FRONTLINE
COMMUNICATIONS

Frontline has maintained ISO 9001:2008 certification without interruption since 2011. This certification goes beyond finished product quality. It is a rigorous, systematic and process-driven approach to organizational quality management – setting requirements for materials, products, procedures, formats, information and documentation. Every Frontline vehicle undergoes a thorough quality management process to ensure Vehicle Quality Excellence, testing mechanical, electrical and systems functionality prior to customer acceptance.





Ground-up Systems Engineering

No hand-offs. Ever. Frontline employs full-time Systems Design Engineers who lead customers from initial concept through detailed design, training and operational support.

From remote-controlled robotics to infrared cameras, our industry-leading integration team has mastered thousands of custom communications systems and upgrades, delivering full turnkey solutions with agility and confidence.



Surface Mount/Accessible Communications Wiring Raceways



Exterior Display Compartment



Touch Screen Multiplex System



Radio/MDT Installation



Custom Workstation Consoles



Custom Designed and Built Power Panels and Wiring Harnesses

A direct path to complex design

Frontline makes the design and build process easy to navigate, manage and understand. Our comprehensive engineering and documentation design packages include:

- Design Consulting and Needs Assessment
- Budget Planning and Analysis
- Conceptual Systems Design
- Ergonomic and Infrastructure Requirements Study
- Detailed Systems CAD Documentation Package
- Equipment Procurement
- Turnkey Installation
- Full Configuration Set Up and Functional Testing
- Comprehensive On and Off Site Training
- Maintenance and Warranties

Frontline Engineering professionals have an in-depth background in complex vehicle design, with experience integrating a multitude of technologies. Our extensive engineering resources and involvement in previous vehicle design projects provide a unique blend of expertise and flexibility to supply comprehensive services required for mission success.



Typical systems include:

High Definition AV Systems
 Touch Panel Controls and Monitoring
 Video Teleconferencing
 Camera Systems: Covert/Surveillance, Low Light, Thermal Fixed, PTZ or Mast Mounted
 Network Video Recorders
 Remote Control and Monitoring
 Satellite HDTV Systems

Multi-image Display Systems
 Redundant Phone and Network Connectivity
 VoIP and Hybrid PBX Phone Switches
 Throw Phone Integration and Enhancement
 WiFi/Mesh Connectivity
 VSAT Satellite Connectivity
 Streaming Real Time Voice, Video and Data
 Event Capturing and Playback

Portable Fiber Optic/Wireless Extended Points of Presence (XPOPs)
 IP Based Radio Systems: True Dispatch Stations, Interoperability Systems
 DSNG Ku Uplink
 Messaging and Video Sharing
 Aircraft Downlink Capabilities
 IP/Network Weather Stations/GIS Systems



C-40 Commercial Chassis Series

The C-40 commercial series is based on a Freightliner M-2 chassis, but can be built with Kenworth, Peterbilt, International or other OEM chassis. This body features up to four optional slide out sections with an interior workstation layout that can be custom configured to fit mission requirements.

- Chassis: Freightliner M2-106 (others available)
- Body Length: 29'-10"
- Overall Length: 40' (up to 45')
- Generator Power: 20 - 30kW
- Slide-Outs: Up to (4) available
- GVWR: 54,000 lb.
- Vehicle Weight: 35,000 lb.
- Payload: 19,000 lb.
- Workstations: 4 to 8+

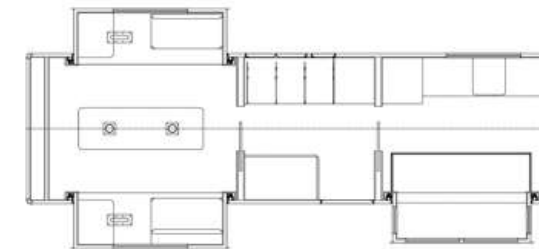

C-43X-4-CC

C-40 Custom Chassis Series

The C-40 custom series features a Pierce® Velocity® or Arrow XT™ chassis, with four optional slide out sections in the conference and forward operations areas to maximize space and comfort. Our most popular command platform can be outfitted with any variety of vehicle options and communications equipment.



C-40X-3

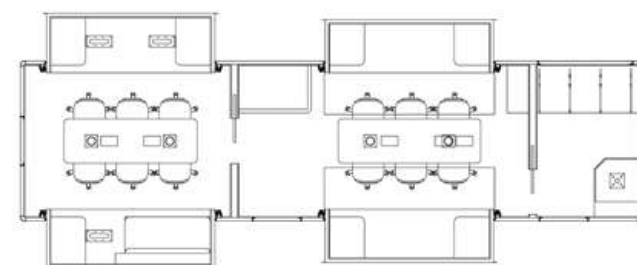

- Chassis: Pierce® Velocity® or Arrow XT™
- Body Length: 31'-3"
- Overall Length: 40'-3" (up to 45')
- Generator Power: 20 - 30kW
- Slide-Outs: Up to (4) available
- GVWR: 65,000 lb.
- Vehicle Weight: 48,960 lb.
- Payload: 16,040 lb.
- Workstations: 4 to 8+



C-35X-3

C-30 Series

The C-30 offers many capabilities of the larger platform in a compact package. The 20' body accommodates up to three slide outs for a staff of 8-10 personnel, and can be set up for longer deployments. Workstations with custom consoles, an exterior monitor/compartments, awnings, and a camera mast are all typical features selected for this platform.

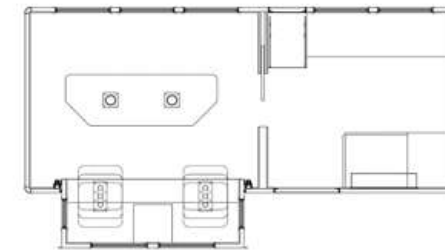

- Chassis: Freightliner M2-106 (others available)
- Body Length: 19'-10"
- Overall Length: 30' (up to 34')
- Generator Power: 20kW
- Slide-Outs: Up to (3) available
- GVWR: 33,000 lb.
- Vehicle Weight: 24,000 lb.
- Payload: 9,000 lb.
- Workstations: 4



C-30X

C-35 Series

The C-35 mid-size platform is available with a dual rear axle or single rear axle for improved mobility in urban areas. This platform can accommodate multiple slide outs, lavatory, galley and cab walk through features among many others. It is ideal for long-term deployments or for use with larger organizations and staff.

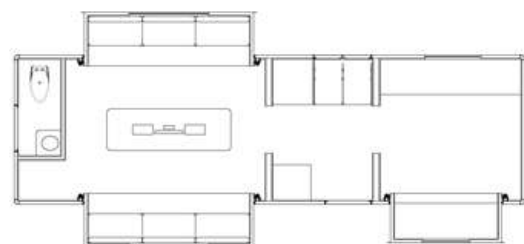

- Chassis: Freightliner M2-106 (others available)
- Body Length: 24'-10"
- Overall Length: 35' (up to 39')
- Generator Power: 20 - 30kW
- Slide-Outs: Up to (4) available
- GVWR: 35,000 lb.
- Vehicle Weight: 27,000 lb.
- Payload: 6,000 lb.
- Workstations: 4 to 6+





C-40 SWAT

C-24 HNV

A dedicated negotiations room built with sound deadening materials. 72" interior heights. A workstation with plenty of power and communications capabilities. The C-24 HNV includes all these features and more in a 24' full size van platform.

- Chassis: Freightliner Sprinter EXT 170WB
- Body Length: 15'-10"
- Overall Length: 24'-1"
- Generator Power: Up to 12kW
- GVWR: 9,990 lb. or 11,030 lb.
- Vehicle Weight: 8,920 lb.
- Payload: 2,110 lb.
- Workstations: 3

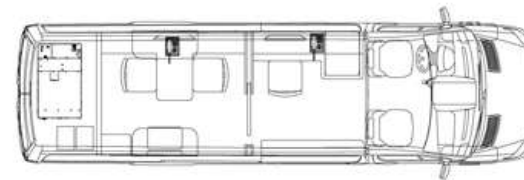

C-40 SWAT

The C-40 SWAT platform was designed with law enforcement agencies to provide complete, secure and ergonomic storage for SWAT equipment. Custom ordnance and equipment compartments for NFDD Flash Bangs or 40mm less lethal and gas munitions, a rear hydraulic lift and communications center are key features included in the C-40 SWAT vehicle.

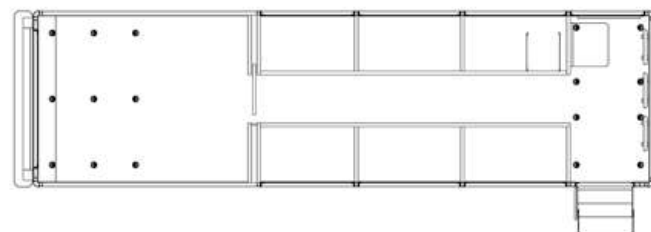

- Chassis: Freightliner M2-106
- Body Length: 29'-10"
- Overall Length: 39'-7"
- Generator Power: 8kW
- GVWR: 54,600 lb.
- Vehicle Weight: 30,000 lb.
- Payload: 21,766 lb.
- Workstations: 1

C-24 HNV





C-41 EOD

Pierce ENCORE Rescues

Pierce® ENCORE® Rescues are built and constructed using modular body sections. Select the body that makes sense for your department and get the rescue that handles your equipment in the most efficient way possible. Command or crew modules. Custom or commercial chassis. Mission applications include SWAT, Air, Light and more. It all adds up to a huge array of options and possibilities.

- Chassis: Peterbilt 337
- Body Length: 19.36'
- Overall Length: 31.5'
- Power: 1kW Inverter
- GVWR: 29,000 lb.
- Vehicle Weight: 19,660 lb.
- Payload: 9,660 lb.

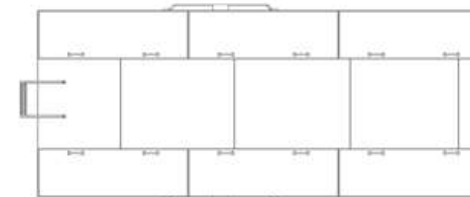

Encore SWAT

C-41 EOD

Explosive Ordnance Disposal. Exactly what this truck was designed and built to do, safely and efficiently. This vehicle includes two ATF Type III explosive proof day boxes, easy access and deploy robot storage ramp and compartment, and a Cisco based communications system. Also featured are HD and thermal cameras, a weatherstation and a Firecom intercom system. This vehicle is available with either a Pierce® custom chassis or commercial chassis and should be part of every emergency response fleet.

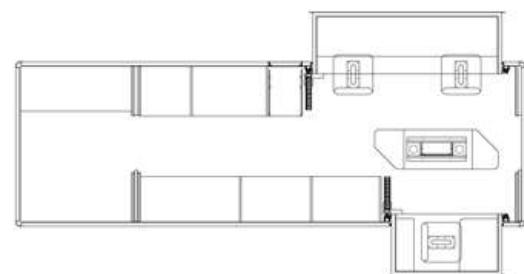

- Chassis: Pierce® Impel®
- Body Length: 26'
- Overall Length: 42.75'
- Generator Power: 20kW
- Slide-Outs: Two
- GVWR: 55,000 lb.
- Workstations: Three



Custom Heavy Duty Aluminum Trays & Shelving



Custom Paint & Graphics



Custom Recessed Power & Connectivity Enclosures



Exterior Monitors



Multiplex Control System

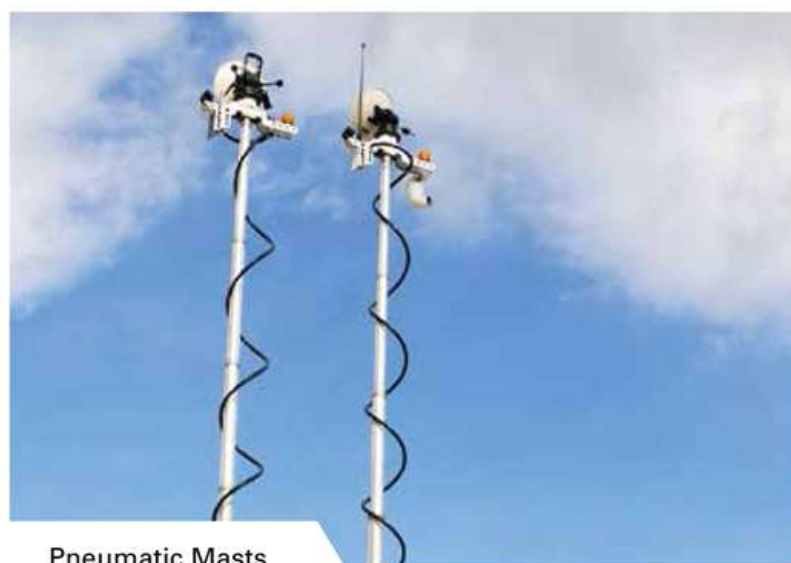

Pneumatic Masts



Sliding Magnetic Glass Boards



Solid Surface Counter Tops

Special options

Frontline excels in building custom vehicles with custom features, from laser etched I/O panels to sliding magnetic whiteboard window covers to one-of-a-kind paint and graphics. No detail is too small when building the highest performing vehicle.

We always remember that some of our best vehicle features were ideas from you. By really listening and understanding, we help more emergency response teams lead.

Features

- Custom Paint and Graphics
- Custom Routing with LED Backlighting
- Exterior LCD Display Installed in Compartment
- Roof Top Diamond Plate Aluminum Storage Box
- Mockett Box Installed in Consoles for Power and I/O Connections
- Custom Multiplex Control System for all AC and DC Equipment with Touch Screen Display
- Solid Surface Countertops
- Whelen-Pioneer LED Scene Lighting
- Emergency Lighting Packages
- Custom Operations Manual
- Cipher Push Button Security Locks with Panic Bar Latch
- Electric Awning
- Pneumatic Masts
- Custom Aluminum Angled Consoles Installed at Workstations
- Sliding Magnetic White Board Window Covers
- Quartet Infinity Magnetic Glass Marker Boards
- Automatic Power Transfer Switch
- Northern Air Commercial Wall Mount HVAC Systems
- Heavy-duty Slide-out Tray on Ball Bearing Slides with Locking Latch, Installed in Exterior Compartment
- LED Underbody Ground/Perimeter Lighting Activated by Switch or Opening of Vehicle/Body Entrance Doors



Safety powers every practice

Frontline is committed to protecting our people, our communities and the environment. We believe that all injuries can be prevented and the full commitment of each team member is required to achieve this goal. Through continued training, involvement and leadership, we can achieve safety excellence. The entire Frontline plant is Oshkosh Certified to Safety Management System - Level III, employing world class fall protection, personal protective equipment and industry-best safety and environmental practices.

- Meet all OSHA standards for workplace safety.
- NFPA 70E Arc Flash (vehicles and facilities).
- Dedicated full-time safety professional on staff.
- In-house safety committee and first responders.
- Exceeded 1 million hours without a lost time accident.



Every level of training imaginable

Frontline provides comprehensive training on the vehicle, sub-systems, and all vehicle equipment at our Clearwater facility during acceptance. We also provide on-site training at the customer's facility to ensure a smooth transition to deployment and operation. On-site training is priced as required based on location and number of training days. Frontline service and engineering is available 24 hours a day for technical and service support.



Systems engineering team

- Professional systems engineering team comprised of highly experienced engineers focused specifically on the communications systems design.
- Approximately 150 years of combined experience.
- Work directly with customer from concept to design to delivery (testing and training).

Experience

- Fields of expertise include broadcast/communications engineering, military comms and AV.
- Federal: NSA, DHS, FBI, DEA, Secret Service.
- State/local: Hostage negotiation, EOD, Ports.
- International: Canada, Nigeria, Morocco, Vietnam, Chile, Saudi Arabia, Afghanistan.



SAFETY MANAGEMENT SYSTEM

Working Towards VPP - An OSHA Cooperative Program



Application Submitted

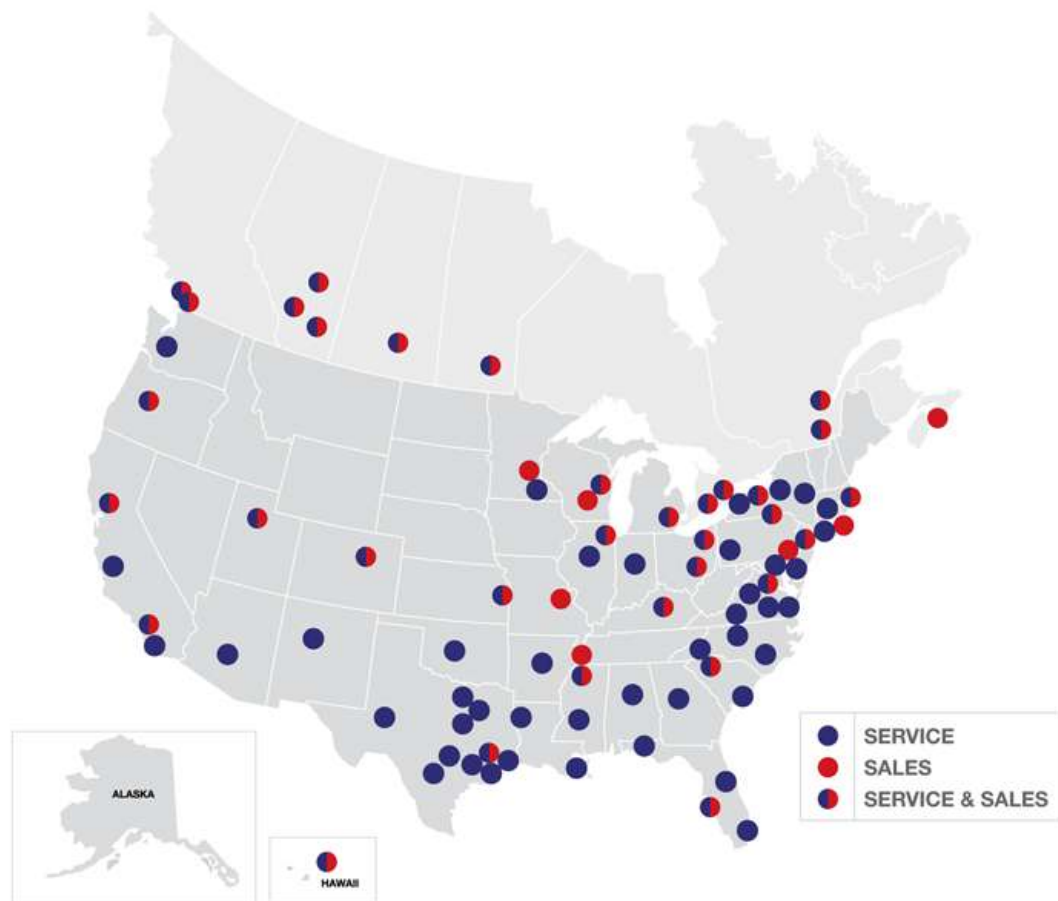

C-24 Hazmat



F-450 EOD



C-17

Custom/specialty vehicles

At Frontline, every vehicle is a custom vehicle, built by hand, one at a time. Let Frontline's engineers and craftsmen design and build your next specialty vehicle.

Service in house and in field – nation wide

Our goal is to ensure your custom vehicle performs at its peak post-delivery and well into the future. Our expert team of in-house Customer Service Representatives and five factory-trained Service Specialists provide unmatched support through 24/7 warranty assistance, complete repair and diagnostic services, and replacement parts assistance. As a part of the Pierce Manufacturing family, our customers enjoy the benefits of a nationwide sales and service facility network, which performs in-house and field service work on all of our specialized vehicles.

Frontline partners with the most dependable dealers and service technicians in the field today to keep your equipment and team firing on all cylinders.

Frontline Services

- 24/7 warranty assistance
- Will-Burt mast / light towers service and replacement
- Chassis preventive maintenance
- Coach repairs: fabrication, assembly, paint
- Communication system upgrades
- Vehicle body remounts and reconditions
- Mobile service unit fleet comes to you
- Maintenance and operational training



C-53TX

www.frontlinecomm.com



An Oshkosh Corporation Company

Frontline Communications,
A Division of Pierce Manufacturing Inc., An Oshkosh Corporation Company
12770 44th Street North, Clearwater, Florida USA | 727.573.0400



Specifications, descriptions and illustrative material in this literature are as accurate as known at the time of publication, but are subject to change without notice. Illustrations may include optional equipment and accessories and may not include all standard equipment. All measurements are nominal values.
© Pierce Manufacturing Inc., Pierce, the Pierce logo and Velocity are registered trademarks; Arrow XT is a trademark; and Perform. Like No other. is a service mark of Pierce Manufacturing Inc. Appleton, WI Printed in USA

All other trademarks are the property of their respective owners.

FL-0001-ERVBR 12/17