

Skid unit with a piston pump

Rotomolded polyethylene tank
High pressure

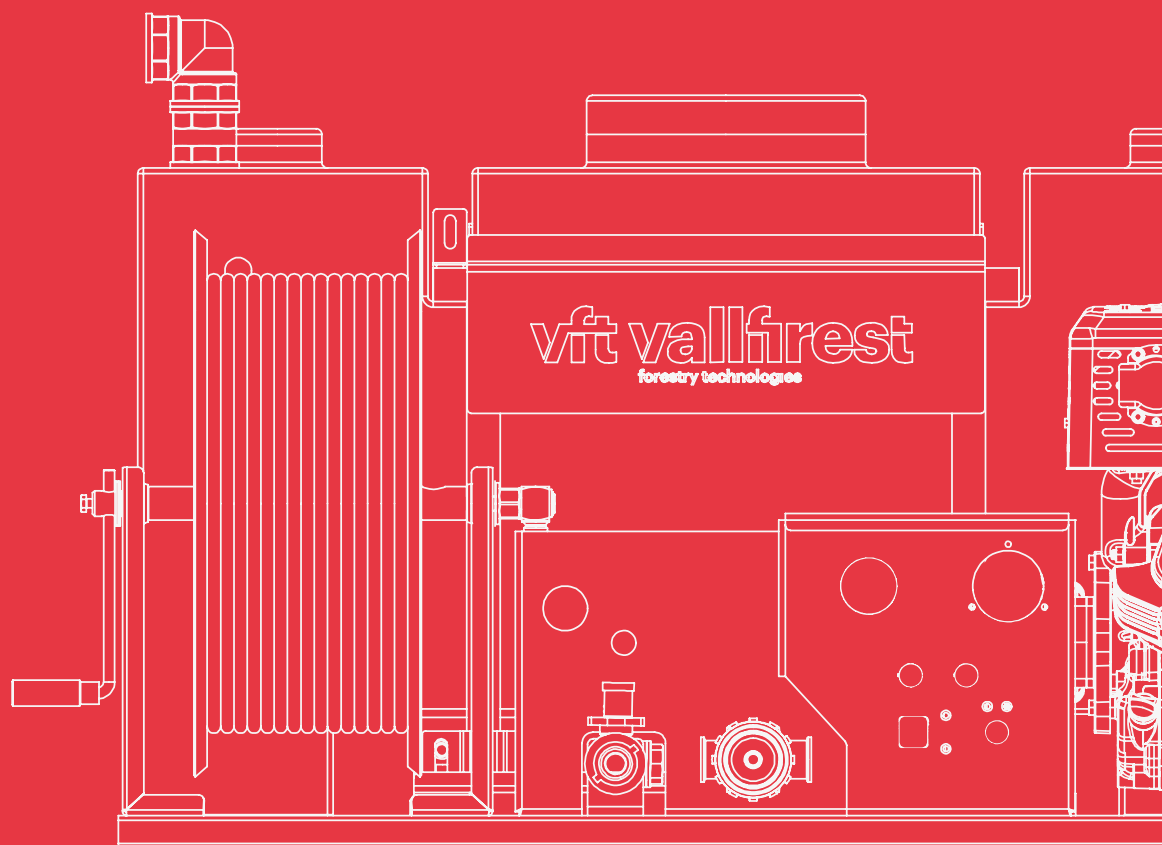

Rotomolded polyethylene skid unit with a piston pump

High pressure | Up to 1,450 PSI

Rapid intervention skid units designed for pickup vehicles and trailers, equipped with piston pumps up to 1,450 PSI with a maximum flow of up to 11.1 Gal/min.

- High-quality components and great replacement part availability
- Durable tanks made of rotomolded polyethylene
- The best quality/price ratio
- 2 year warranty



What is included?

Motor	Gasoline 11,7 HP
Piston pump	11.1 gal/min. 1,450 PSI
Quick attack hose reel	Equipped with a 1/2" high-pressure hose
Water tank	105 Gal
Attack nozzle	Multi-purpose water and foam
Suction hose	16.4 feet long
Foam-forming agent proportioner system	included

Uses

Wildland fires	Less recommended
Container and vehicle fires	Recommended use
Cleaning and unclogging	Recommended use

1 Motor pump unit

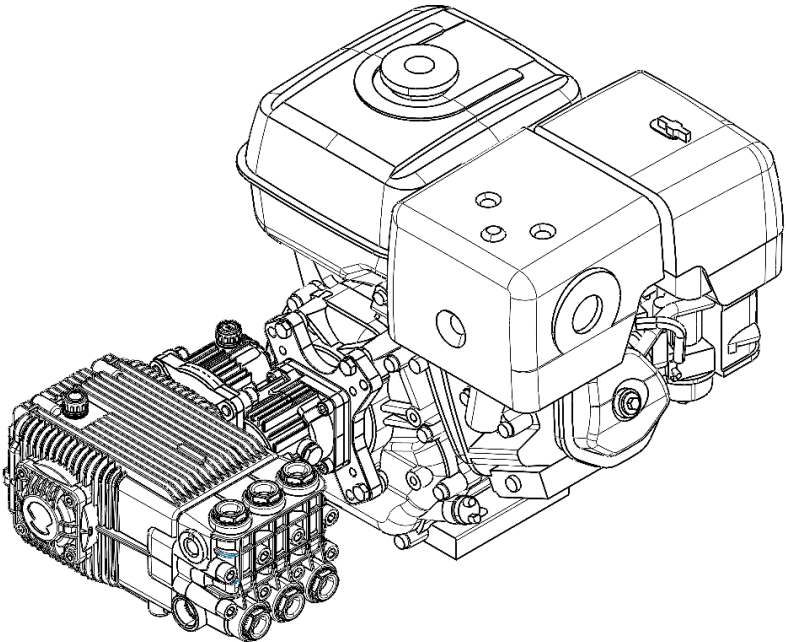

Motors	Power *	Pump	Max. pressure **	Max. flow **
Honda GX390	11.7 HP	XWL 42.10 N	1,450 PSI	11.1 Gal/min

☐ Gasoline motor.

* The nominal engine power indicated in this document is the net power tested on a production engine for the engine model pursuant to SAE J1940 at a specific speed. This value may vary in mass produced motors. The actual output power of the engine installed on the end machine will vary depending on a number of factors such as the applicable engine operating speed, the environmental conditions, maintenance and other variables.

** These values are at direct pump outlet.

*** The power, pressure and flow values are valid in working conditions: temperature 25°C at sea level. **IMPORTANT:** Engine power will decrease 3.5% for every 300 meters above sea level and 1% for each 5.6°C above 25°C.



HONDA

2 Water tank

Polyethylene tanks make the entire skid unit lighter. Vallfirest skid units with a polyethylene tank are designed to concentrate the skid unit load in the area closest to the vehicle cabin, avoiding wheel arches on pickup vehicles and optimizing the available space.

- Made of seamless polyethylene via rotational molding.
- 2 longitudinal baffles to prevent water from moving to the side to ensure vehicle stability.
- 1 1-1/2" filling spout on the top with couplings to fill the tank from a hydrant or exterior pressurized water source.
- 1 configurable 1-1/2" high vent on the top.
- 1 threaded inspection cover with a useful diameter of 200 mm to inspect the tank.
- A water level indicator over connecting ducts.
- A conveniently 3/4" drain to empty the tank.
- Pump return connection to oill the tank by drafting.
- The tank connects to the vehicle with lateral mounting points .
- Black natural color.

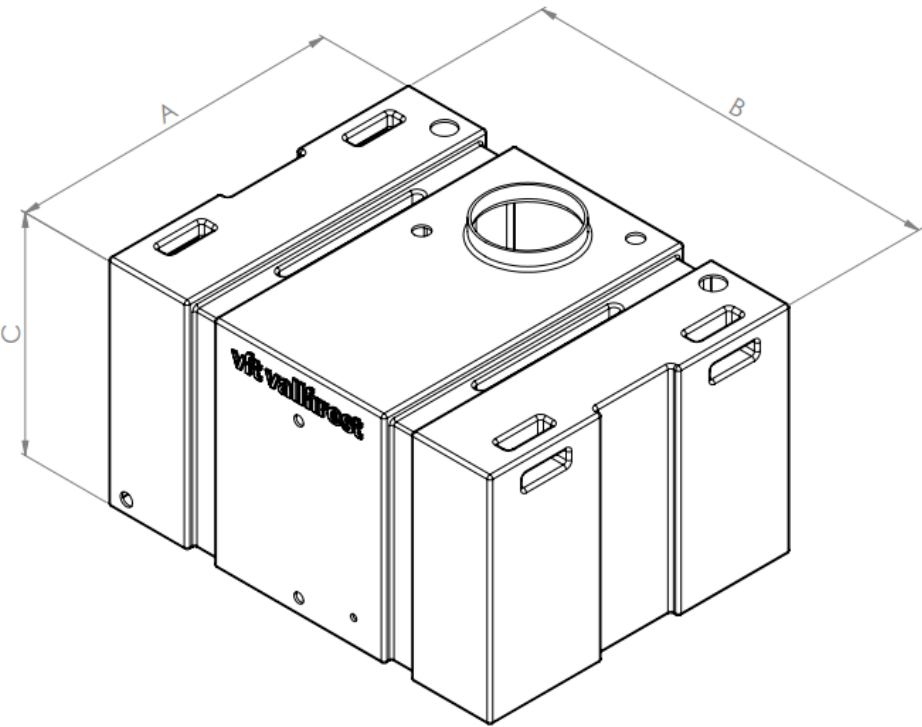

A: Depth
B: Width
C: Height

Standard colors		Tank dimensions		
Black		Tank	A [inch]	B [Inch]
		105 Gal	31.49	41.33
				21.85

3 Components included

3.1 Control panel

Control panel with LED light switch, pressure gauge, time counter, pressure regulator, filter, valves for suction and water drive, and foam percentage regulation knob.

TECHNICAL DATA

- Baked paint coating



3.2 Hose reel

Made of anti-corrosive material with a manual starting crank and lock system.

TECHNICAL DATA

- Capacity for 100 feet (30m) long DN12 hose*



3.3 Hose

DN12 (1/2") rigid hose. Comprised of an inner layer of synthetic rubber reinforced with 1 metal mesh (R1AT). Features a quick connection system for a multi-purpose water and foam nozzle.

TECHNICAL DATA

Hose type as per the operating pressure:

- SAE 100 R1AT DN12 (1/2"): 2,320 PSI operating pressure



3.4 Foam-forming agent proportioner system

Compact and easy-to-use, foam mixing with a proportional manual selector valve. Creates a stable mix of foam-forming agent in the water. Venturi effect "in line eductor" system which mixes water and foam-forming agent in the drive circuit.

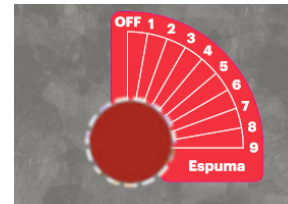

3.5 Suction hose

Clear flexible PVC spiral suction hose with rigid PVC spiral and smooth inner surface. Includes non-return foot valve and filter. Includes a Storz connector for connection to the Vallfirest skid unit.

TECHNICAL DATA



- Length: 16.4 feet
- Suction hose diameter: DN 1"



3.6 Multi-purpose nozzle

High-pressure and high-range nozzle for water and foam. With quick connection system.*

TECHNICAL DATA

- Maximum pressure: 250 bar
- Maximum flow: 45 L/min.
- Concentrated stream > 
- Hollow cone/fog stream > 
- Foam stream > 



4 General Dimensions

DIMENSIONS [inch]

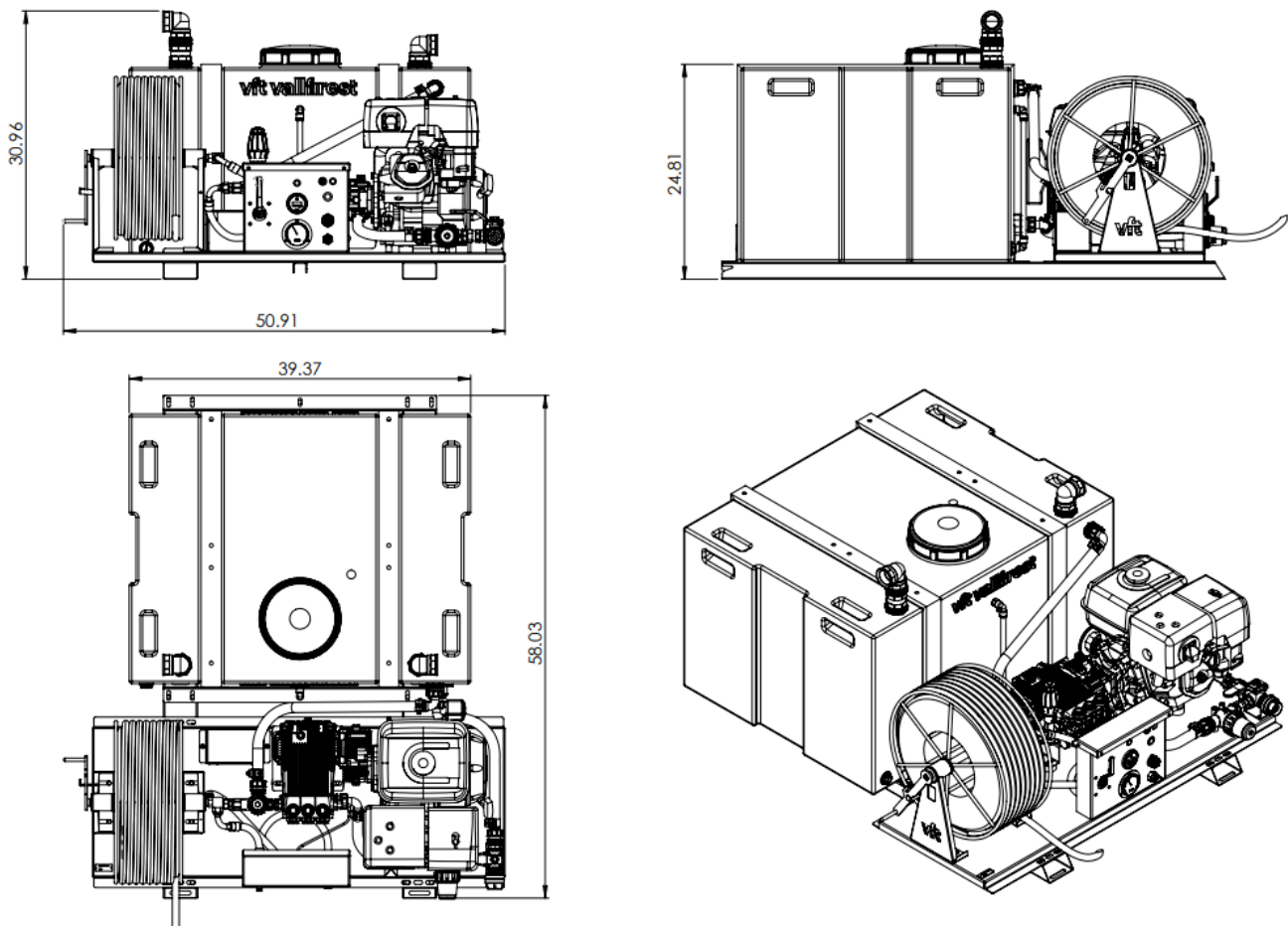

5 Configurations available

Ref. VFT	Tank	Motor	Battery and electric start	Power *	Pump	Max. Pressure **	Max. flow **	Aprox dry weight
DVS134V-G63A0	105 Gal	Honda GX390	YES	11.7 HP	XWL 42.10 N	1,450 PSI	11.1 Gal/min	446 lbs

☐ Gasoline motor.

* The nominal engine power indicated in this document is the net power tested on a production engine for the engine model pursuant to SAE J1940 (Honda) at a specific speed. This value may vary in mass produced motors. The actual output power of the engine installed on the end machine will vary depending on a number of factors such as the applicable engine operating speed, the environmental conditions, maintenance and other variables.

** These values are at direct pump outlet.

*** The power, pressure and flow values are valid in working conditions: temperature 25°C at sea level. **IMPORTANT:** Engine power will decrease 3.5% for every 300 meters above sea level and 1% for each 5.6°C above 25°C.

Any questions? Contact us: info@vallfirest.com | T. 1-970-988-0389

www.vftnorthamerica.com